

VENUSTA

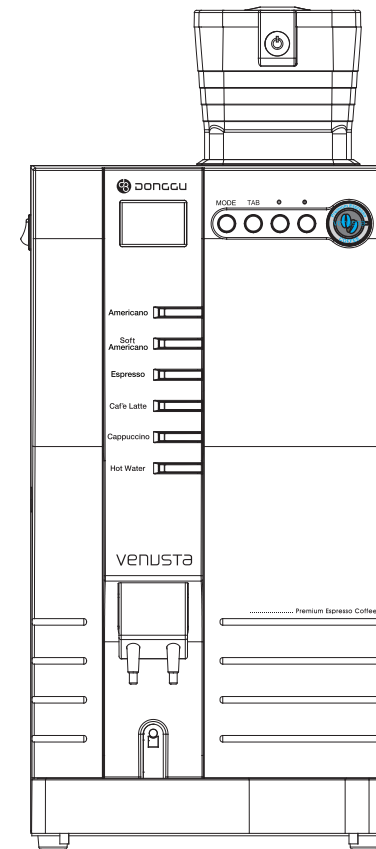

Espresso Machine

Model : DSK-E06-FB



 **Dong Gu Co., Ltd**

500-5, Sangdaewon-Dong, Sunnam, Gyeonggi-Do, Korea
Tel. 82-31-731-3600 ext. 730 / 731
Fax. 82-31-733-1155
Email. info@venusta.net

Features

- 1** Elegant European Espresso Machine
Grind the bean just before brewing allows to enjoy a deep aroma and soft flavor.
- 2** Fully Automatic Micom System
The easy to use Micom Control System enable to control any function conveniently.
- 3** Smart Brewing System
No need to change the brewer as per coffee ground dose and versatile brewing chamber can hold various coffee ground dose according to user's preference.
- 4** Fully Automatic Bean to Cup System
Just touch a button leads you to have a nice cup of coffee, fully automatically from bean to cup.
- 5** Able to adjust hot water temperature at personal preference
Enable to make more tender and thicker espresso shot through hot water temperature control quite freely.
- 6** Easy to use and control with LCD Display
All process of bean to cup can be shown at LCD screen, which allows the easy to use and control.
- 7** Easy Maintenance
Usefull instruction displayed in LCD let user know when take care of cleaning ,refill and check internal components.

Contents

1. Features-Contents	1
2. Note / Accessories	2
3. Description of Parts	4
4. Installation – Bean Hopper	5
5. Installation – How to fit and fill powder canisters	6
6. Installation – Pump connected type	7
7. Installation – Water Filter connected type	8
8. Installation – Adjust coffee bean grinder level	9
9. Reset brewer / Clean the internal components automatically / Water supply	10
10. Set beverage volume	11
11. Hot water temperature setting	12
12. Count Cup	13
13. Vend Test	14
14. Bean Volume Test	15
15. Cup Sensor Setting	16
16. Recipe Reset	17
17. Set waste box alert	18
18. Sugar dose preselection mode	19
19. Set sugar dose adjust-unit	20
20. Price setting	21
21. Hot water button setting	22
22. Trouble shooting Guide	23
23. Disassemble components	24
24. How to clean and cleaning scedule	25
25. How to replace fuse / Specification	27

Note



In operating

1. Ginder

- ☞ It might cause troubles in **mixing small stone piece or worden piece** with coffee bean.
The after service following above cause is compensation by customer.
- ☞ The grinding volume can difference following kind & size of coffee bean.

2. Brewer Mech'

- ☞ Daily maintenance– **brewer should be clean 1times above every day.**
- ☞ Do not set up very little volume bean powder because it might cause discharge error of bean.
- ☞ Min. volume of bean: **Above 5gram**(Level of bean volume: From 5~12g)
- ☞ It might cause trouble in touch during operation or disassemble machine parts.

3. Others

- ☞ **Install the machine inside the office room**– this can prevent down of 1st drink temperature or material hard.
- ☞ The drink volume can exchange following using condition.
- ☞ The drink volume **set up is based on 7oz cup** and if the drink volume is little temperature of 1st drink can be low.

Accessories

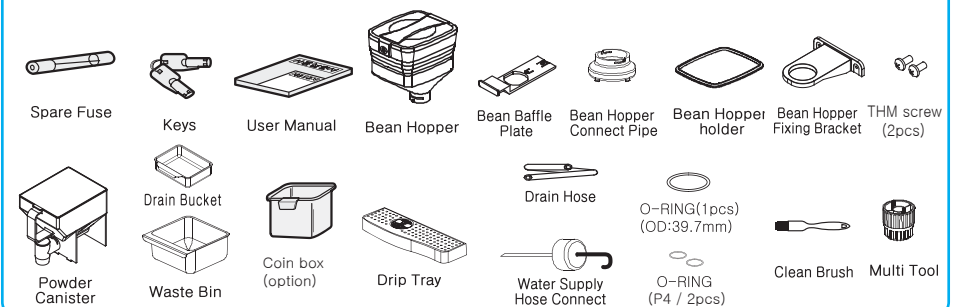

Optional water filter connect set

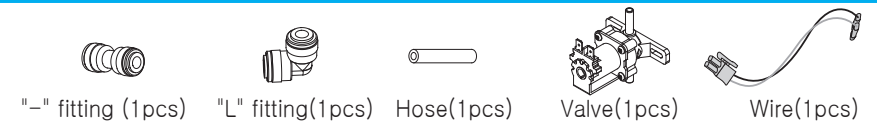

Note

This section refers all instruction to use product in safe and correct way. Be sure to follow all instructions to prevent any accidents and danger.

Warning The warning mark refers possibility of significant danger, death and fire if user do not follow instructions.

Caution The caution mark refers possibility of damage, injury and loss if user do not follow instructions.

Electricals

Warning Be sure to use only grounded outlet when connect the electrical plug to the outlet.

- It might cause fire or electric shock.

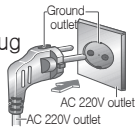

Warning Do not connect multiple plugs of appliances to one outlet at the same time and do not connect electrical plug to outlet when the outlets is loose.

- It might cause fire.

Warning Stop operation when the plug and outlet is damaged.

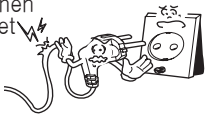

- It might cause electric shock or fire.
- Be sure to call your local A/S service team to repair it.

Warning Do not handle the power cord with wet hand.

- It might cause fire or electric shock.

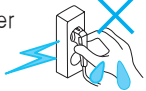

Warning When stop operating the machine for a long time, unplug power to the machine and empty bean hopper & canisters.

- It might cause trouble.

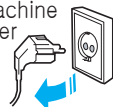

Installation

Warning Do not disassemble without confirmation from authorized service agent.

- Might cause electric shock or fire.

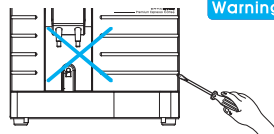

Warning Do not clean with water on machine directly or with benzene, thinner.

- Electrical shock or damage in parts by any chance.

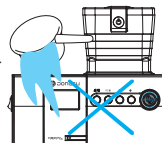

Installation

Warning Do not keep inflammables near by machine or put it into.

- It might cause explosion, fire and injury.



Warning Use of subterranean water, tap water cause problem in operation due to calcification. Recommend to use only the water filtered by UF Membrane filter.

Caution Be sure to operate the machine for indoor-use only at room temperature.

- It might cause burst in winter when keep it outside.
- It might cause an electric leakage and fire due to rain or snow.
- At the place below 0°C, be sure to turn on machine.

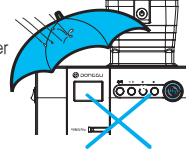

Caution In winter season, there would be a possibility of freeze and burst. Make sure to use the equipment at room temperature and keep turning power on.

✳️ Manufacturer will not be responsible for any damages or troubles caused by freeze and burst.

Description of parts

Front

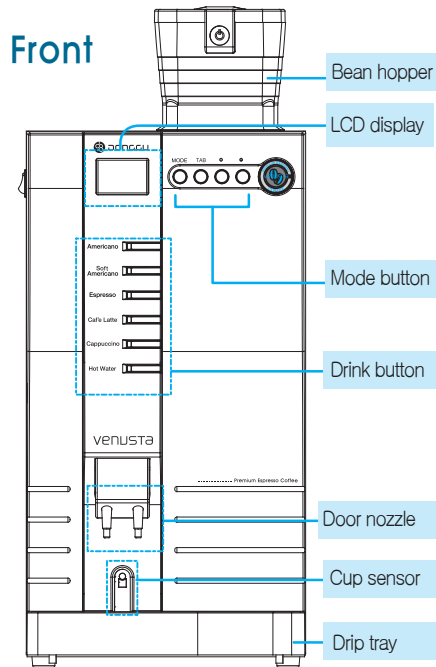

Door inside

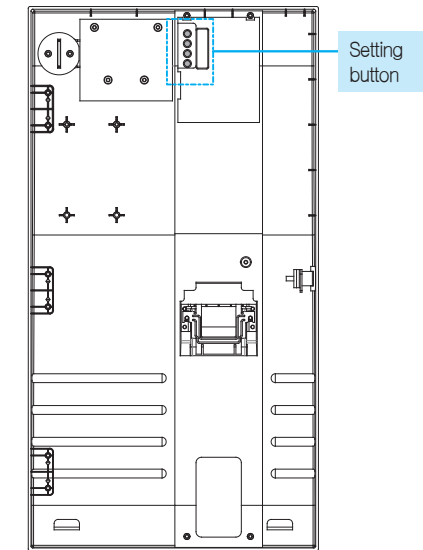

Inside

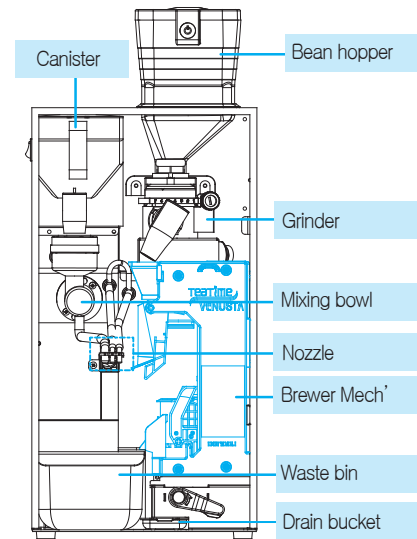

Rear side

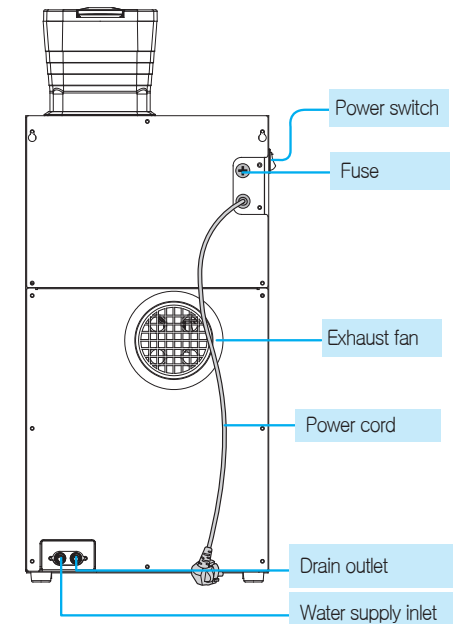

Installation and Precaution

How to fit and fill bean hopper

- 1 Fit bean hopper holder groove into square hole on upside of machine.
Press bean hopper connecting pipe downward and fit to the grind level disk.

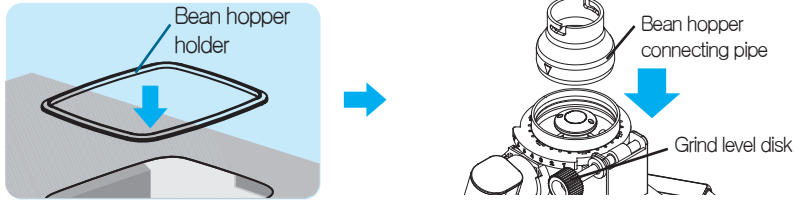

- 2 Fit the clamp connect-cani into the bean hopper connecting pipe as figure.
Then screw THM Screw(2pcs) to the hole of main chassis and the fixing bracket tightly. (THM Screws packed in the accessory part.)

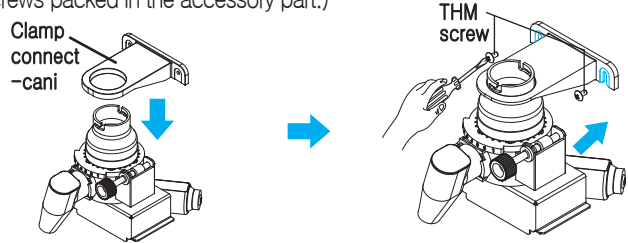

- 3 Fit the bean hopper into hole of the bean hopper holder as figure.
Turn the bean hopper connecting pipe anticlockwise to fix it.

Caution ● The bean hopper can be removed during operating unless fix it.

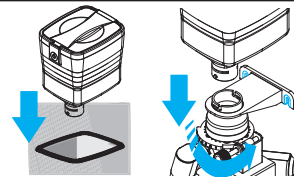

- 4 Fit the bean baffleplate into the bean hopper hole and push the plate completely to get the bean outlet open

Caution ● When do not push the plate completely, the bean is not able to be supplied to grinder, which cause trouble in vending a cup.

Note. ● ①Close ②Open

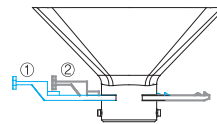

- 5 Unlock the bean hopper lid with key.

Fill the bean hopper with coffee bean. After fill out the hopper, close the lid and lock.

Caution ● Be sure to use roasted whole bean only, not pre-ground coffee.
● pre-ground coffee cause trouble.
● recommend to use Arabica coffee bean for espresso and do not use over roasted bean.

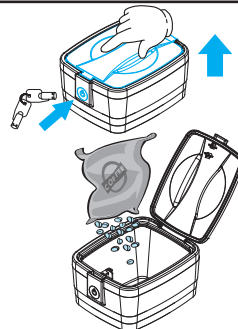

Installation and Precaution

How to fit and fill powder canisters.

- 1 Lift the canister up slightly and pull front part of canister toward user.

Caution ● Remove any wetness inside of canister perfectly to prevent ingredients from being solid.
Then put ingredients into canisters.

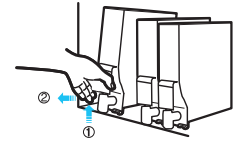

- 2 Fill canisters with toppings correctly and close canister lid.

Caution ● When filling up ingredients, Be sure to rotate the ingredient chute so that it points up (loading position).
And slide canister backward and hold it carefully to prevent spilling.
● When filling up ingredients, do not tamp the ingredient.
It might cause ingredient being solid and blocking ingredients outlet.

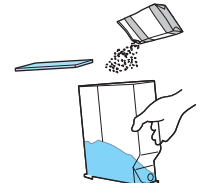

- 3 Fit the fixing hole of canister into the rotation shaft correctly as shown.

● Be sure to check label on canister and panel if each canister is fitted to the correct position.

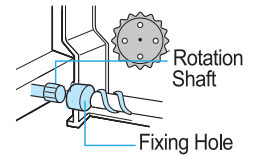

- 4 Fit the jut in bottom of canisters into panel hole correctly.

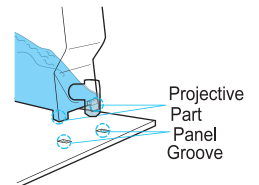

- 5 Fit the bean hopper into panel then place the ingredients dispense guide as shown in figure.

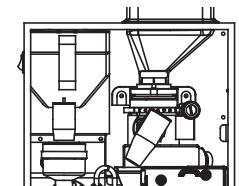

Note. Canister Capacity

Cream	Bean
800gr	1,200gr

※ ①Mix coffee : 1,100gr ②Sugar : 1,300gr

Installation and Precaution

※ Depending on the water used might cause calcification inside of internal components.
 Recommended to check it in every 6 months to prevent any problem in machine working.
 Be sure to use water filtered by UF Membrane filter.

● Pump connected type

- 1 Clean the machine.
 Place the machine on a flat level.

- Caution**
- If it is not leveled, it might cause noise.
 - Space of 15cm from wall is required when install.

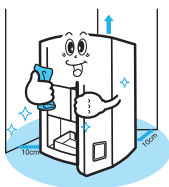

2 Connect water supply hose

1. Connect water supply hose to pipe connector at rear side of machine.
 ※ (1) connect pipe – silicone hose (2) water bottle – hose

2. Put the bottle cover on spout of bottle completely.

- Caution**
- Be cautious to prevent the sliced side of the hose from clinging to the internal side or bottom of the bottle. (It might cause problem in water supply)
 - Be sure to use the cover to prevent that any impurities may get into the bottle. It might cause trouble.

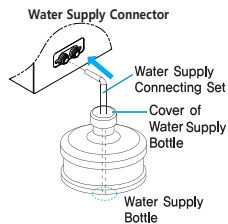

Connect drain hose

1. Drain Bottle should be installed below side of machine.
2. Adjust the length of drain hose properly to let the drain hose 5~10cm below from the top of the bottle.

- Caution**
- If the hose and drain bottle is not installed incorrectly, it might cause water back flow into machine.
 - If the drain hose would be bent, it might cause water back flow.

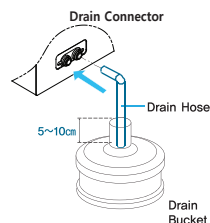

- 3 Fill the powder canisters with each product, such as choco, cream, sugar, coffee bean.

※ After filling, install the grinder as instructed at page 9.
 ※ Please refer to page 5~6 to fill the canisters.

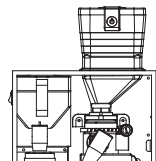

- 4 Be sure to plug in its own grounded electrical outlet.
 Turn on power switch at the right side of machine.

- 1) Machine works to supply water to water reservoir and heater tank.
- 2) When finish heating, the machine is on standby condition.

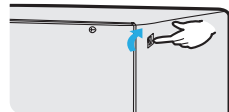

- 5 Insert coins and then press drink button to select.
 When LCD screen displays "enjoy a cup", take out the cup.



Installation and Precaution

● Water filter connected type

※ The water filter connect set is optional.

- 1 Unscrew the rear side lower panel with screw driver.
 Unscrew and remove the water supply pump bracket as shown in figure and then remove the plastic cover for protecting PCB.
 Disconnect the connector which is connected to the pump and the hose (2 at top and lower).
 Then unscrew the water supply pump.

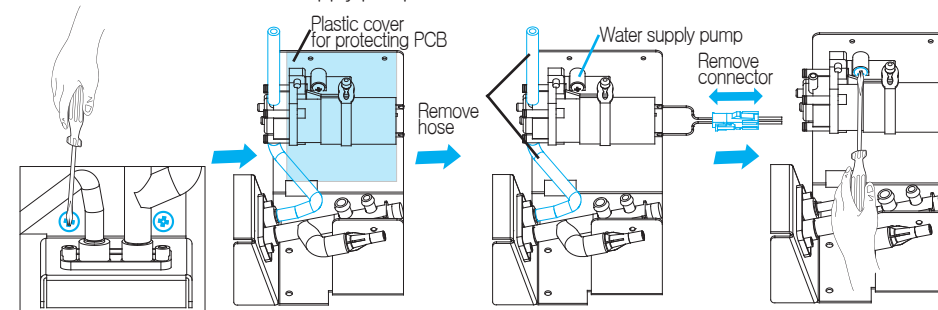

- 2 Connect the water supply valve(①), "L" valve (②), hose(③), "-" fitting(④), connecting wire (⑤) as figure.

- The arrow marked on water supply valve should be upward (↑) direction, when assemble it. In case the arrow direction is downward, it cause a water leakage.
- The water pressure from the water filter system need to be more than 1kg/cm². In case the pressure is over 4kg/cm², need to use water pressure reducing valve or middle valve additionally.
- In case the water pressure is low, remove the check valve for better water supply. when the pressure from the filter system is low, there would be trouble in water supplying to the built-in water reservoir.

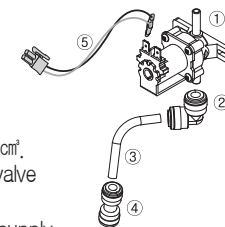

- 3 Put the "-" fitting(①) assembled in water supply valve into the connecting pipe and make sure to get the fitting connected straight.

Fix the water supply valve to the bracket with the two screws.
 Connect the valve connecting wire (②) and put the hose from water filter into water supply hose connecting point. Then screw the lower back plate.

※ When the product is not sold for long time or turn off the machine, be sure to use the ball valve between the hose from water filter and the water supply hose connecting point and should close the ball valve to prevent any water leakage. Manufacturer will not be responsible for any trouble caused by user's fault ignoring this warning to recommend using the ball valve under the condition stated as above.

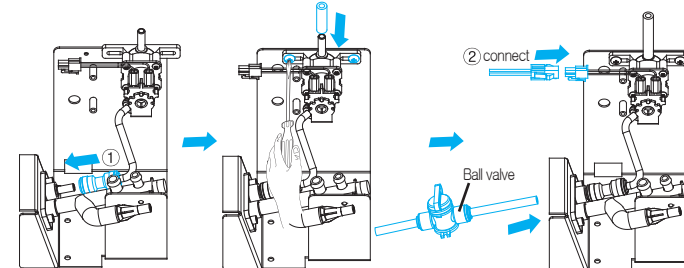

Installation – adjust coffee bean grind level

How to adjust coffee bean grind level

1 Able to adjust the level by rotating the worm lever equipped in the upside of grinder.

- The grind level is verified from 1 to 7 level and factory setting level is 4.
- If set at too fine or too coarse level, it might cause trouble in extracting espresso. Recommend to set at from 3 to 5 level.

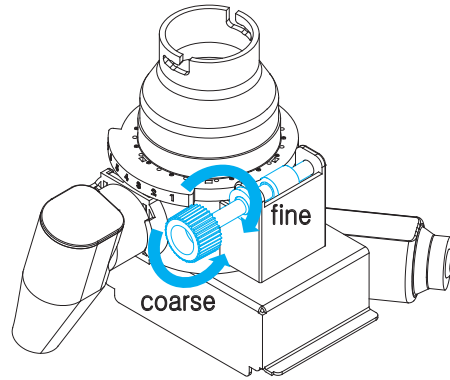

How to install Grinder

1. press the mode button inside of front door.
2. Press the mode button 5 times then " Bean Volume Test " displayed on LCD.
* Refer to " Bean Volume Test ".
3. Press any menu button 2 or 3 times to test bean volume and to fill the grinder with ground bean.

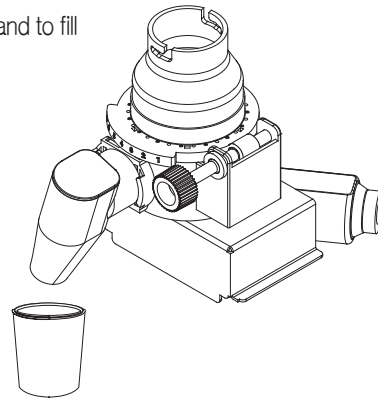
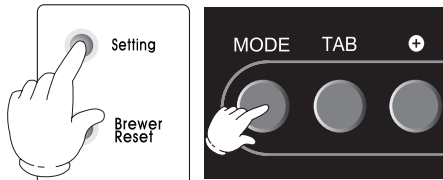

Tips when the bean chute is blocked

1. remove the bean chute by turning it.
2. remove any impurities inside of grinder with small brush.
3. fit the bean chute then do the above instruction, " install grinder ".

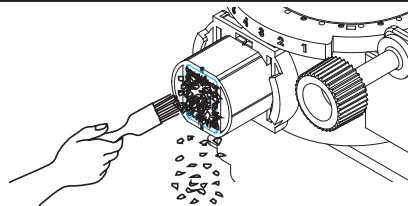

Reset Brewer

- 1 A function to get brewer to "standby condition".
 - Press the brewer reset button inside of front door then brewer moves to standby mode position.
 - " Brewer excursion error " is due to brewer motor or some damage in circuit. When this message is displayed in LCD, need to call authorized local A/S service team.

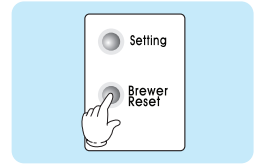

Clean the internal Components automatically

- 1
 - Press the button one time : clean brewer
 - Press the button two times : clean mixing bowl of sugar
 - Press the button long time once : clean the water circuit in turns

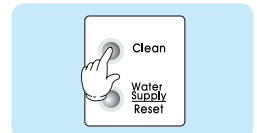

- 2 Empty the drip tray.

- **Caution** During cleaning, be cautious at the flowing hot water through dispense nozzle.
- After cleaning, be sure to empty the drip tray.

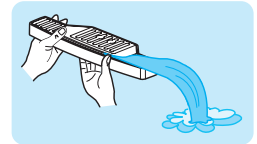

Water Supply

- 1 Press the water supply button inside of front door then water is supplied to water reservoir.
Water will be fed to the reservoir until the upper water level sensor in the reservoir is reset.

- At condition of standby mode, water is supplied at every 5 minutes automatically.

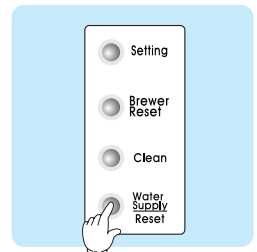

Set beverage volume

1 Press the setting button inside of front door.



Set Mode
Press mode button

2 Press the mode button in front panel one time.

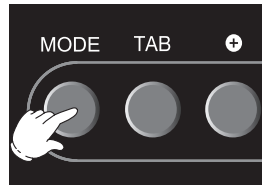

Ingredient volume
Select drink button to adjust

3 Press the drink button to adjust volume.

Ex) When adjust espresso, press espresso button, can adjust each product and water volume.

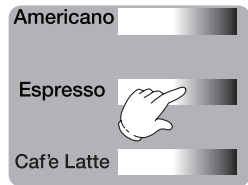

Espresso
bean : 4.0 wat: 40cc
mix : 0.0 wat: 00cc
hotwater: 00cc

4 Press +/- button in the front panel to adjust.

Note. ● To go next item, press "tab" button.

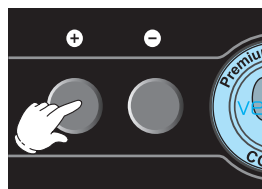

Espresso
bean : 4.2 wat: 40cc
mix : 0.0 wat: 00cc
hotwater: 00cc

5 Adjust recipe setting per powder product you want to use.

- When you use Sugar for the powder canister, need to adjust the setting per each product.
- When you use premix powder (ex. 3 in 1 instant coffee),
 - (1) The ingredient volume setting for Americano, Soft Americano, Espresso need to be set at "0"
 - (2) The bean volume and beverage volume setting for Café Latte, Cappuccino need to be set at "0", adjust the ingredient volume and water volume for the powder product.

6 After setting, press the setting button inside of front panel. Then the adjusted setting value will be stored with beep sound.



Refresh Time With VENUSTA
Select Drink button

Hot Water Temperature Setting

1 Press setting button inside of front door.



Set Mode
Press mode button

2 Press mode button in front panel two times.

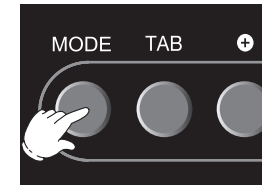

Set Hotwater Temp.
Set the +/-button
H.W Temp: 98°C

3 Adjust hot water temperature with the +/- button.

- Setting temperature range : 60~98°C

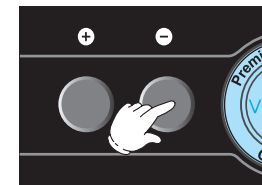

Set Hotwater Temp.
Set the +/-button
H.W Temp: 96°C

4 After setting, press the setting button inside of front panel. Then the adjusted setting value will be stored with beep sound.

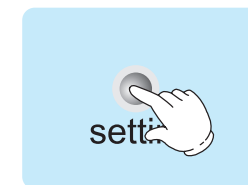

Refresh Time With VENUSTA
Select Drink button

Count Cup

1 Press setting button inside of front door.

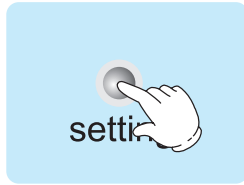

Set Mode

Press mode button

2 Press mode button in front panel three times.

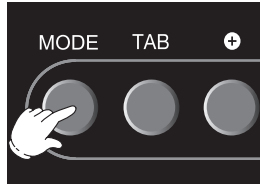

Count Vend cup

Select drink button to count

3 Press a menu button to count.

Ex) When select espresso



● Count free or paid cup per each menu is available.

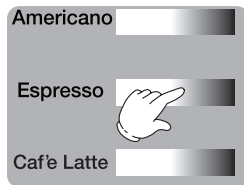

Espresso:	100
Paid:	50
Amount:	5000
Free:	50

4 Press "Tab" button to check the total free / paid cup.

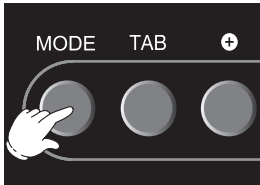

Total:	1100
Paid:	50
Amount:	5000
Free:	1050

5 After counting, press the setting button inside of front panel. Then return to standby mode with beep sound.



Refresh Time With VENUSTA

Select Drink button

Vend Test

1 Press setting button inside of front door.

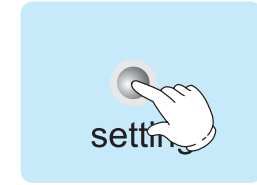

Set Mode

Press mode button

2 Press mode button in front panel four times.

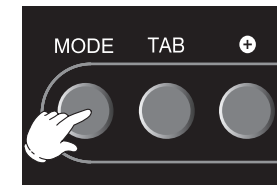

Vend test

Select Drink button to test

3 Press the menu button to test espresso.

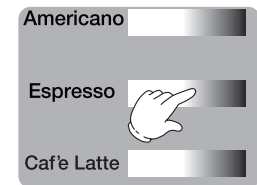

Espresso test

4 After testing, press the setting button inside of front panel. Then return to standby mode with beep sound.



Refresh Time With VENUSTA

Select Drink button

Bean Volume Test

1 Press setting button inside of front door.



Set Mode

Press mode button

2 Press mode button in front panel five times.

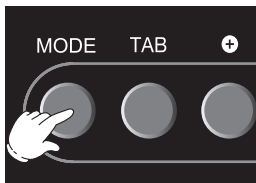

Bean Volume Test

Select Drink button to test

Remove brewer

3 Place a cup just below the bean chute and press drink button to test.

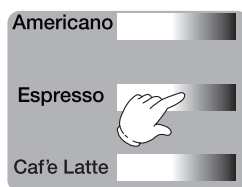

Bean Volume Test

Select Drink button to test

Remove brewer

Note. ※ Need to remove brewer prior to test and refer to page 24.

4 Check the bean volume poured into cup.

- Need to check if the bean volume is appropriate and when adjustment is necessary, adjust the bean volume. (Ref. page 11)



Bean Volume Test

Select Drink button to test

5 After testing, press the setting button inside of front panel. Then return to standby mode with beep sound.



Refresh Time With VENUSTA

Select Drink button

Cup Sensor Setting

1 Press the setting button inside of front door.



Set Mode

Press mode button

2 Press mode button in front panel six times.

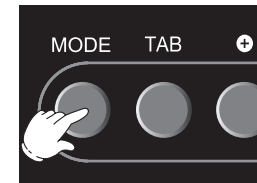

Set Cup Sensor

With the +/- button

Cup Sensor: On

3 Press the +/- button to activate the cup sensor.

- On : The sensor need to recognize the cup in order to serve beverage
- Off : Regardless of the sensing cup, beverage will be served.

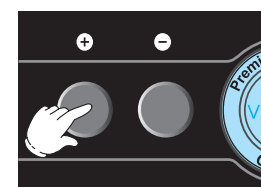

Set Cup Sensor

With the +/- button

Cup Sensor: Off

4 After setting, press the setting button inside of front panel. Then the adjusted setting will be stored with beep sound.



- When the sensor is set at "off", user should place a cup at the station to get the beverage dispensed from the nozzle.

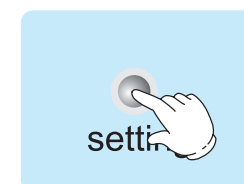

Refresh Time With VENUSTA

Select Drink button

Recipe Reset

Make sure that all stored information will return to factory settings after reset.

1 Press setting button inside of front door.

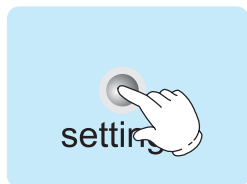

Set Mode

Press mode button

2 Press mode button in front panel seven times.

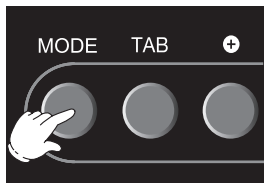

Reset ingredient vol.

Set with +/- button

Reset: No

3 At the recipe reset mode, press the +/- button to select "yes" or "no". If need to reset to factory setting, Press the "Tab" button long over 3 seconds,

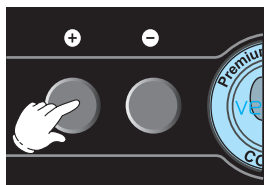

Reset ingredient vol.

Set with +/- button

Reset: Yes

- "Yes": Reset all stored recipe setting value.
- "No" : Keep current recipe setting.

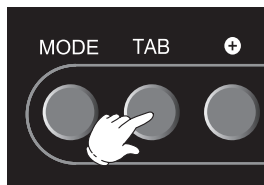

Reset ingredient vol.

Set with +/- button

Reset: Done

4 After setting, press the setting button inside of front panel. Then the adjustment will be stored with beep sound.



Refresh Time With VENUSTA

Select Drink button

Set waste box alert

1 Press setting button inside of front door.



Set Mode

Press mode button

2 Press mode button in front panel eight times.

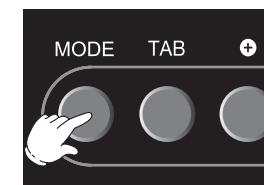

Set waste box alert

Press +/- button to set

Alert: Off

3 Set the full of waste box alarming mode with the +/- button.

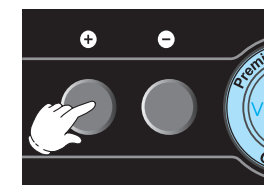

Set waste box alert

Press +/- button to set

Alert: On

- On : The alarming function will work.
- Off : The alarming function won't work.
- Press the setting button inside of door to reset the full of waste box alarming message on LCD Screen.

4 After setting, press the setting button inside of front panel. Then the adjustment will be stored with beep sound.

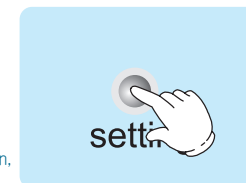

Refresh Time With VENUSTA

Select Drink button

- When this alarming message displayed on LCD screen, must empty the waste box.

Sugar dose preselection mode

※ This function need to be used only when sugar is used for the powder canister.

1 Press setting button inside of front door.



Set Mode

Press mode button

2 Press mode button in front panel nine times.

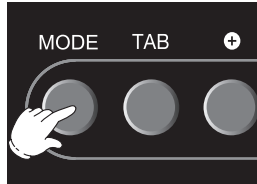

Preselection set

Press +/- button to set

Preselection: Off

3 Set the sugar dose preselection mode with the +/- button.

● When this mode set at " On ", user can adjust the sugar volume as they want prior to press the menu button.

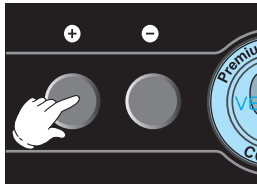

Preselection set

Press +/- button to set

Preselection: Off

4 After setting, press the setting button inside of front panel. Then the adjusted setting value will be stored with beep sound.

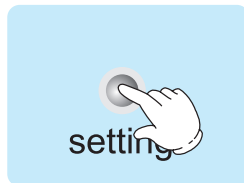

Refresh Time With VENUSTA

Select Drink button

Set sugar dose adjust – unit

※ This mode will be displayed only when the preselection mode is activated.

1 Press setting button inside of front door.

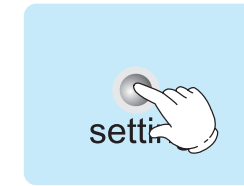

Set Mode

Press mode button

2 Press mode button in front panel ten times.

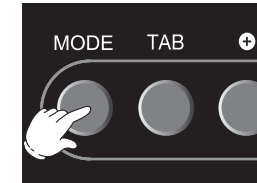

Set Sugar Dose unit

Set adjust unit with the +/--button

Unit: 0.1sec

3 Adjust sugar dose unit with the +/- button.

● Setting range : 0.1 ~ 0.5 second

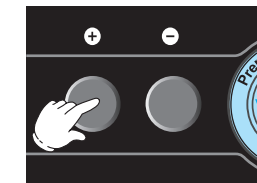

Set Sugar Dose unit

Set adjust unit with the +/--button

Unit: 0.3sec

4 After setting, press the setting button inside of front panel. Then the adjusted setting value will be stored with beep sound.



Refresh Time With VENUSTA

Select Drink button

One time Sugar + / – function

Function to enable consumers to add or decrease sugar for personal preference, which works just one time.

1. Adjust sugar dose with sugar +/- button.
2. Press the drink button when LCD displays sugar dose.

※ When pass 5 seconds after pressing sugar +/- button, return to standby condition automatically.



Price Setting



※ This price setting is applied to the model with coin mechanism only.
For the model without the coin mechanism, make sure to set the vending price at "free (0)".

1 Press setting button inside of front door.



Set Mode

Press mode button

2 Press mode button in front panel eleven times.

- When the preselection mode is activated, press the clean button 11 times.
- When the preselection mode is inactivated, press the clean button 10 times.

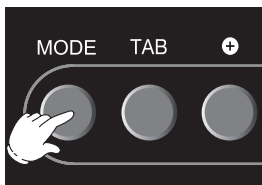

Set price

To adjust select Drink button

3 Press the menu button to set price.
Ex) When select espresso,



Espresso : 0

Select drink button to adjust

4 Adjust the price with the +/- button.

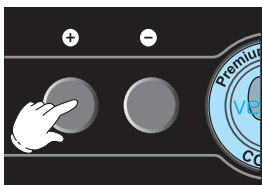

Espresso : 100

Select drink button to adjust

5 After setting, press the setting button inside of front panel.
Then the adjustment will be stored with beep sound.



Refresh Time With VENUSTA

Insert Coin

Hot water button setting

1 Press setting button inside of front door.

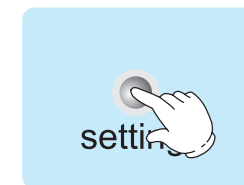

Set Mode

Press mode button

2 Press mode button in front panel twelve times.

- When the preselection mode is activated, press the clean button 12 times.
- When the preselection mode is inactivated, press the clean button 11 times.

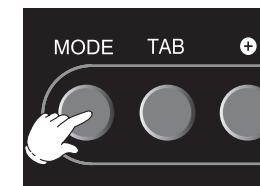

Hot water button set

Press +/- button to set

Hot water: On

3 Set the mode with the +/- button in front panel.

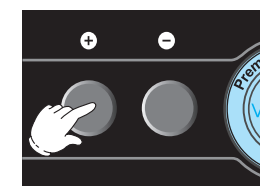

Hot water button set

Press +/- button to set

Hot water: Off

4 After setting, press the setting button inside of front panel.
Then the adjustment will be stored with beep sound.





Refresh Time With VENUSTA

Insert Coin



Trouble shooting Guide

※When the following troubles happen repeatedly, need to call the authorized local A/S service team to check.

Error Message	Check Points	Trouble shooting
brewer location error 	1. check the brewer location state 2. check the brewer fit-check switch.	reassemble the brewer correctly. refer to page 24. replace the switch with new one.
brewer excursion error 	1. check if encoder PCB terminals of brewer is unconnected.	need to reconnect the terminal well. replace the PCB if the terminals is connected well
no water 	1. check the water is enough in water reservoir 2. check the connections of water supply hose 3. check if the water supply pump works well. 4. check if the water level in the reservoir reach to the highest level.	fill the water enough and press the water supply button inside of front door. reconnect the hose well. replace the pump. replace the float switch in water reservoir.
hot water temperature is low. please wait... heating.....	* In case this message is displayed longer than 10 minutes, 1. check the connections of heater tank wires. 2. check the anti-over heating device	reconnect all wires correctly. press the top of anti-over heating device
top thermistor error	1. check the connection of top thermistor	reconnect it correctly
hot water supply error turn off power and check	1. check the connection of flow meter. 2. check the vibrating pump.	reconnect all terminnals correctly replace the pump
communication error	1. check all harness of internal communication	reconnect communication harness. LCD PCB : CN3 point Slave PCB : CN7 point

Disassemble components

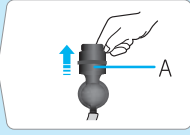
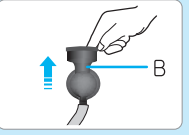
How to remove mixing bowl

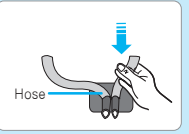
- Remove canister then pull the 'A' part up, as below figure. 
- Pull 'B' part up, as below figure. 
- Pull out the mixer counter-clockwise direction, as below figure. 
- Disconnect hose by pulling out the upper part of the hose connected to ingredient dispense holder. 

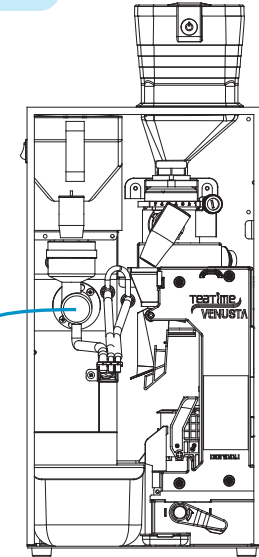

How to remove the exhaust fan cover

- Turn off machine
- Unscrew the exhaust fan cover.
 - Be sure to turn off machine before remove the cover. It might cause injury

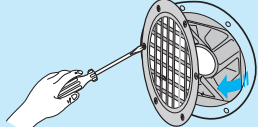

How to remove Brewer

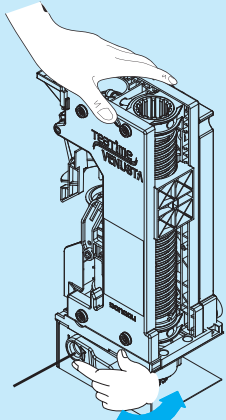

While rotating the handle brewer ejector upward, remove brewer by lifting it up.

How to assemble Brewer

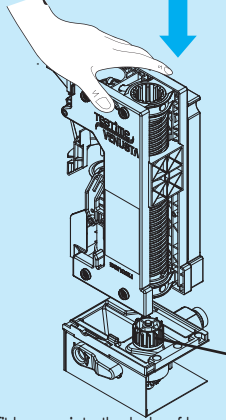

Fit brewer into the hole of brewer motor. Brewer motor press the brewer reset button then brewer motor starts working to place brewer in standby position.

How to clean and cleaning schedule

※ Be sure to unplug the power cord before cleaning.

Cup Station / Sensor

Wipe with damp cloth

- Remove moisture completely.
- Clean cup station more one time in a day.

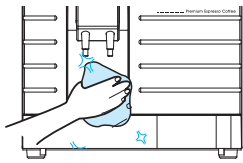

Ingredient(topping) Canister

Put the canister into water and soak ingredients solid and stuck to canister in water.

- Then wash out with a soft sponge.
- Assemble after remove moisture completely.
- Clean canisters more one time in a month.



Drip Tray / Waste box / Drain Bucket

1. Empty the containers and clean inside with water
2. Need to check if the waste box and drain bucket is full to prevent overflow. (more once in a day)
 - * It can cause troubles or unsanitary condition.
3. If stop the machine working for a long time, need to clean the above containers completely.



Exhaust Fan

Remove dust around the fan with small brush.

- Must turn off power prior to clean.

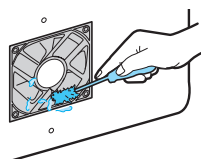

Exhaust Fan Cover

Put and soak in water then wash out ingredients powder and dust.

- And remove moisture completely.
- Refer to 'disassemble components' at page 24.

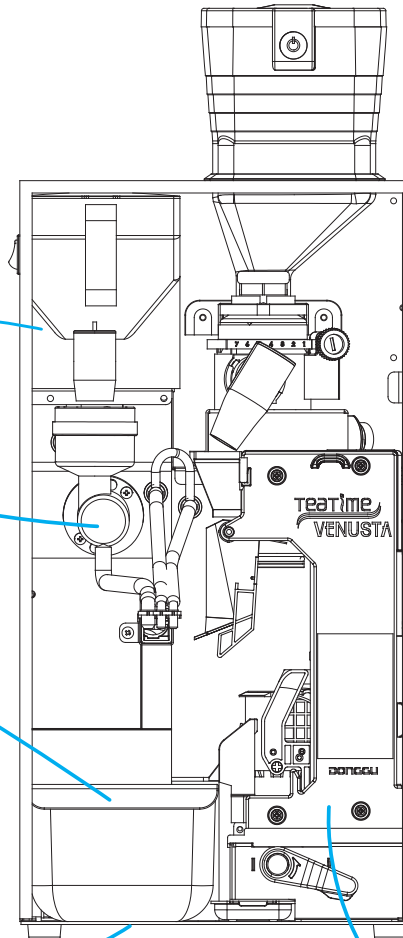

Clean Brewer

- ※ To keep better taste and quality of espresso coffee, need to clean and maintain brewer periodically.
- ※ Recommended to clean brewer frequently.

1. Refer to the page 24, how to remove brewer. While putting the multi tool on brewer, turn it anticlockwise to the end then the lower piston move up to be easy to clean.
2. Pull the chute middle upward.
3. Pull and remove the coffee sludge guide as shown in figure.
4. Turn brewer backward and wash the water inlet fitting part with flowing water.
 - ※ This part is a route feeding hot water to extract espresso. If this line is blocked by coffee ground, hot water feeding and extracting espresso is not available. Must clean this part first of all.

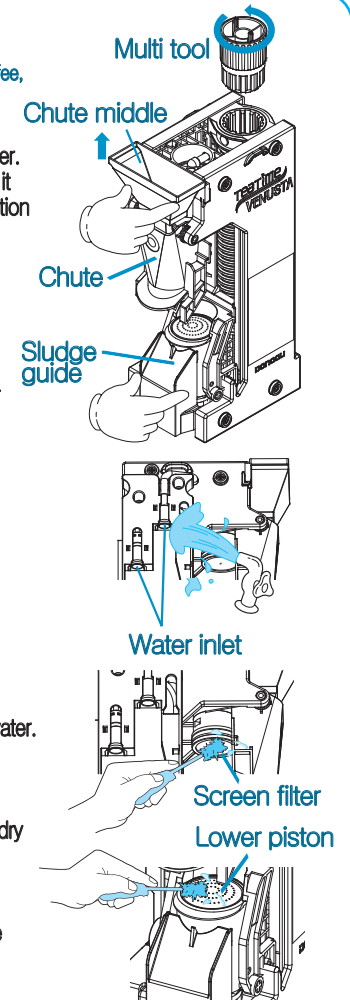

5. Clean the lower piston and screen filter with small brush.
6. Wash the left, right, housing inside (cylinder, screen filter inside) with flowing water.
7. Remove moisture in brewer.
8. Wipe the inside of chute dry with paper or dry cloth to remove moisture.
9. Reassemble the chute middle and coffee sludge guide and fit brewer well then place grinder chute in original position.

< Cleaning schedule >

- ☞ When "Remove Brewer then clean it." message is displayed on LCD screen, clean brewer part as instructed above.

< Monthly cleaning >

- ☞ Need to check lubrication state of internal connections and working parts once in a month.
- ☞ Check the damage or defect in O-ring of upper & lower piston and screen filter.



Do not use volatile cleaning agents, thinner, benzene, solvent, etc for cleaning. It might cause trouble or injury.

How to replace fuse

Fuse is an overcurrent protection device.
Replace with standard new fuse (250V – 15A), when fuse is broken.
* Replace current fuse.

Replace fuse

1 Be sure to unplug power cord when replace.

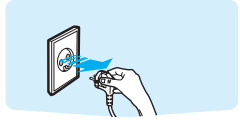

2 Unscrew the fuse holder.

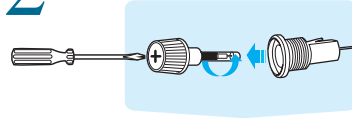

3 Replace the broken fuse with new one.

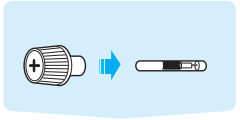

4 Close the fuse holder

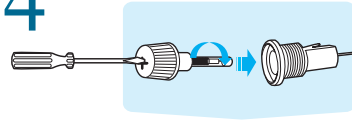

Warning !

Be sure to replace the broken fuse with standard new fuse.(250V – 15A)

- With unstandardized fuse might cause fire.

Specification

Model	DSK-E06-FB
Electricity	220V / 60Hz
Power Consumption	1,400W
Thermostat	Bi-Metal Type (works at 125 °C)
Water Tank Capacity	860mL
Canisters	1(Cream) / 1 (Bean Hopper)
Display	LCD
Control System	MICOM
Weight	27Kg
Dimension	615 (h) x 320 (w) x 476 (d)

MEMO

A series of horizontal dotted lines for writing on page 29.

A series of horizontal dotted lines for writing on page 30.